

Schedule "C"

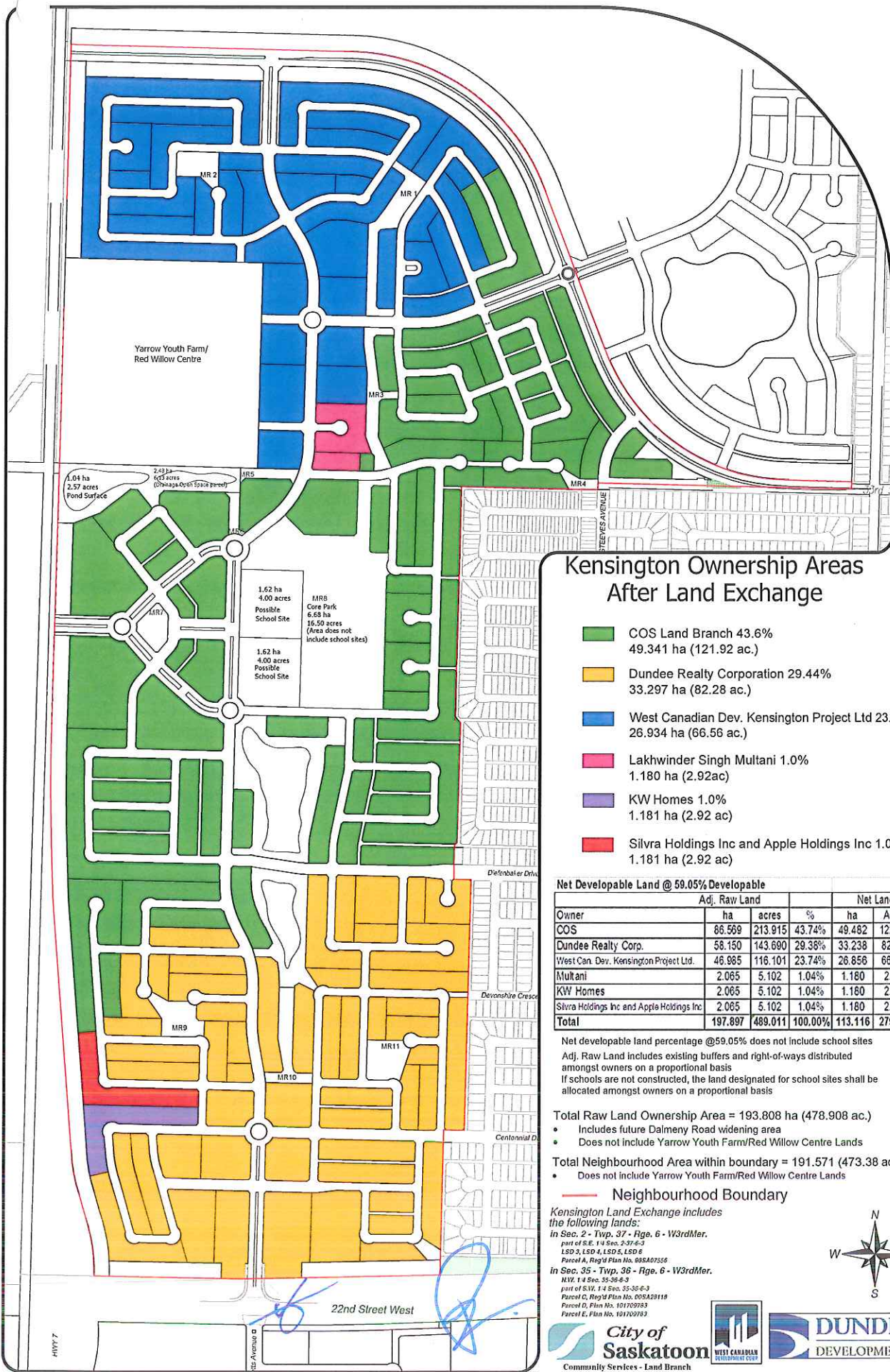

Kensington Ownership Areas After Land Exchange

- COS Land Branch 43.6%
49.341 ha (121.92 ac.)
- Dundee Realty Corporation 29.44%
33.297 ha (82.28 ac.)
- West Canadian Dev. Kensington Project Ltd 23.8%
26.934 ha (66.56 ac.)
- Lakhwinder Singh Multani 1.0%
1.180 ha (2.92ac)
- KW Homes 1.0%
1.181 ha (2.92 ac)
- Silvra Holdings Inc and Apple Holdings Inc 1.0%
1.181 ha (2.92 ac)

Net Developable Land @ 59.05% Developable

Owner	Adj. Raw Land			Net Land	
	ha	acres	%	ha	Acres
COS	66.569	213.915	43.74%	49.482	122.272
Dundee Realty Corp.	58.150	143.690	29.36%	33.238	82.132
West Can. Dev. Kensington Project Ltd.	46.985	116.101	23.74%	26.856	66.362
Multani	2.065	5.102	1.04%	1.180	2.916
KW Homes	2.065	5.102	1.04%	1.180	2.916
Silvra Holdings Inc and Apple Holdings Inc	2.065	5.102	1.04%	1.180	2.916
Total	197.897	489.011	100.00%	113.116	279.514

Net developable land percentage @59.05% does not include school sites
 Adj. Raw Land includes existing buffers and right-of-ways distributed amongst owners on a proportional basis
 If schools are not constructed, the land designated for school sites shall be allocated amongst owners on a proportional basis

Total Raw Land Ownership Area = 193.808 ha (478.908 ac.)

- Includes future Dalmeny Road widening area
- Does not include Yarrow Youth Farm/Red Willow Centre Lands

Total Neighbourhood Area within boundary = 191.571 (473.38 ac.)

- Does not include Yarrow Youth Farm/Red Willow Centre Lands

Neighbourhood Boundary

Kensington Land Exchange includes the following lands:

in Sec. 2 - Twp. 37 - Rge. 6 - W3rdMer.
 part of S.E. 14 Sec. 35-35-6-3
 LSD 2, LSD 4, LSD 5, LSD 6
 Parcel A, Reg'd Plan No. 09SA07256
 in Sec. 35 - Twp. 36 - Rge. 6 - W3rdMer.
 W1/2, 1/4 Sec. 35-35-6-3
 part of S.W. 1/4 Sec. 35-35-6-3
 Parcel C, Reg'd Plan No. 09SA28118
 Parcel D, Plan No. 101709285
 Parcel E, Plan No. 101709192

